

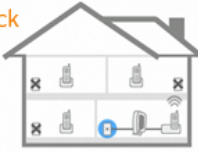

## AT&T U-verse Voice Self Installation

### One Wall Jack

One phone connected directly to the Gateway



### Avoid potential installation charges by selecting Self Installation.

Our easy to follow Online Interactive Assistant will guide you through the installation process and in less than thirty minutes you can enjoy all the features and benefits of AT&T U-verse Voice.

### Do you qualify for U-verse Voice Self Installation?

- Do you have existing U-verse TV or High Speed Internet service?
- Do you have a monitored home alarm?

If you have a monitored home alarm, you will need professional installation by an AT&T Technician and are not eligible to use the Self Installation option.

Customers eligible for self installation who select this option will be shipped an installation kit to their home address (shipping & handling charge applies). The installation kit will contain all of the necessary equipment and access to our **Online Interactive Assistant** for easy, step-by-step instructions.

### You will need:

1. The battery backup
2. A phone cord



### Installation Options

We offer two installation options to choose from depending on your home's layout.

Both options require the use of a battery backup-up unit which is supplied in the kit. Please refer to the battery backup-up information on our website for additional details.

**Please do not attempt installation of U-verse Voice until your installation due date. You will receive your installation due date when you place your order or check your U-verse Voice Welcome e-mail.**

#### Option 1: Plug and Play capability.

This option allows for the use of one phone connected directly to the Gateway. (Please note that if you choose this option, all of the wall jacks in the home will no longer work.)

- Connect phone cord to Line 1 & 2 port on the Gateway.
- Connect the other end of the phone cord to your phone or cordless phone's base station.
- Check to make sure the base station is plugged into an electrical outlet
- Connect the battery backup unit.
- Activate your service by calling the activation number.

### All Wall Jacks

Allows for the use of all the wall jacks in your home.

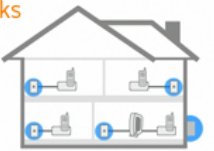

#### Option 2: Use Existing Phone Jacks.

Allows for the use of all the wall jacks in your home (an existing phone jack must be located near the Gateway)

Disconnect the outside phone line.

1. Make sure you have flathead screwdriver to open your phone box.
  - Go outside and find your phone box (usually a gray/tan/black box on the side of the house).
  - Open the phone box by removing the screw.
  - Disconnect the phone cord by unplugging it from the phone jack.
  - Close the box and screw shut.
2. Install Y-Splitter included in the kit in the wall jack by the Gateway.
  - Remove the existing cord from wall jack (if in use) and replace with the Y-Splitter.
  - Connect the existing cord into one port on the splitter.
  - Connect the phone cord supplied with the kit to the other port.
3. Connect phone cord to Line 1 & 2 port on the Gateway.
4. Connect the battery backup unit.
5. Activate your service by calling the activation number.

This option enables all of the wall jacks in your home to continue to work.

### Disconnect the outside phone line.

Find your phone box.

Open the phone box.

Disconnect the phone cord.



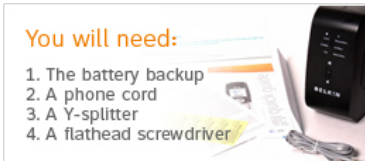

**You will need:**

1. The battery backup
2. A phone cord
3. A Y-splitter
4. A flathead screwdriver

### Connecting your Battery Backup Unit

**Turn off your Gateway:** Power down your Gateway by unplugging the Power Adapter. You will no longer need this power supply.

**Add the Battery Backup Unit:** Connect the Battery Backup by plugging the round connector into the Power port on the Gateway. Then connect the electrical plug to an electrical outlet. Switch the power to On. You should see a blinking then steady green Power light to indicate a successful connection.

**Customers who select the Self Installation Option can also take advantage of reduced pricing on the purchase of select AT&T Dect 6.0 Cordless phone models once your AT&T U-verse Voice order has been placed.**

Please visit: <http://att.com/uversephones> for additional details and to place your phone order.

